



FEATURES AND SPECIFICATIONS

Features and Benefits

- Very strong offset electrodes for higher force applications
- Offset electrodes are for hard to reach locations
- Long lasting, heavy duty electrode
- Can be used in many job shop applications
- Works with all industry standard holders
- Can be redressed many times

Use With

- Fits 4RW or 5RW CMW standard holders

Mechanical

- Electrical conductivity up to 80% IACS
- Rockwell hardness up to 83 HRB

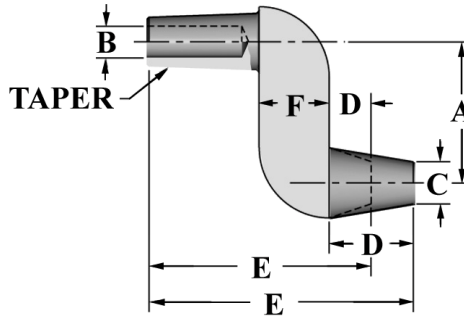

ELECTRODES
BENT

ORDERING INFORMATION AND DIMENSIONS

TAPER	NOSE LENGTH	OVERALL LENGTH	PART NO.	OFFSET	WATER HOLE DIA.	FACE DIA.		MATERIAL	TYPE
	D	E		A	B	C	F		
RWMA 4	3/8	2	16-3860	1-1/4	9/32	3/8	5/8	CMW®3	FORGED
	3/4	2-3/8	16-3861						
RWMA 5	3/8	2	16-3862	1-1/4	3/8	3/8	5/8	CMW®3	FORGED
	3/4	2-3/8	16-3863						