



**FEATURES AND SPECIFICATIONS**

**Features and Benefits**

- Shank/Cap System reduces electrode expenses in high volume and gun applications
- Use with male caps
- Made of CMW®3 material

**Use With**

- Male cap electrodes

**Mechanical**

- Electrical conductivity up to 80% IACS
- Rockwell Hardness up to 83 HRB

SHANKS

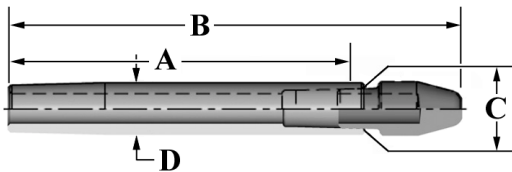

RWMA TAPER	DIMENSION	
	C	D
4	.3735	.482
5	.4135	.625
6	.4995	.750

**ORDERING INFORMATION AND DIMENSIONS**

RWMA TAPER								
4			5			6		
DIMENSIONS (in inches)		PART NO.	DIMENSIONS (in inches)		PART NO.	DIMENSION (in inches)		PART NO.
A	B		A	B		A	B	
1.25	1.88	3012	1.25	2.00	3022	1.50	2.62	3043
1.50	2.12	3013	1.50	2.25	3023	1.75	2.88	3044
1.75	2.38	3014	1.75	2.50	3024	2.00	3.12	3045
2.00	2.62	3015	2.00	2.75	3025	2.25	3.38	3046
2.25	2.88	3016	2.25	3.00	3026	2.50	3.62	3047
2.50	3.12	3017	2.50	3.25	3027	2.75	3.88	3048
2.75	3.38	3018	2.75	3.50	3028	3.00	4.12	3049
3.00	3.62	3019	3.00	3.75	3029	3.25	4.38	30412
3.25	3.88	30112	3.25	4.00	30212	3.50	4.62	30414
3.50	4.12	30114	3.50	4.25	30214	3.75	4.88	30416
3.75	4.38	30116	3.75	4.50	30216	4.00	5.12	30418
4.00	4.62	30118	4.00	4.75	30218	4.25	5.38	30420
			4.25	5.00	30220	4.50	5.62	30422
			4.50	5.25	30222			