



## SHANKS, BENT OFFSET FOR MALE CAPS

### FEATURES AND SPECIFICATIONS

#### Features and Benefits

- Shank/Cap System reduces electrode expenses in high volume and gun applications
- Use with male caps
- Made of CMW®3 material
- Bent shanks are used for hard to reach applications using male caps
- Provided with Water Tube

#### Use With

- Male cap electrodes

#### Mechanical

- Electrical conductivity up to 80% IACS
- Rockwell hardness up to 83 HRB

SHANKS

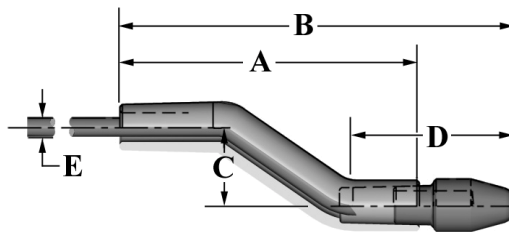
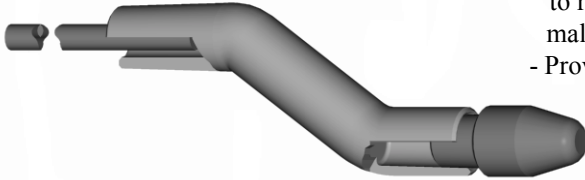

*BENT DIMENSIONS FOR REFERENCE ONLY*

### ORDERING INFORMATION AND DIMENSIONS

RWMA TAPER	DIMENSIONS (in inches)		PART NO.	DIMENSIONS (in inches)		
	A	B		C	D	E
4	2.62	3.37	3019-08	0.50	1-5/8	0.182
	2.56	3.31	3019-12	0.75		
	2.81	3.56	30112-12	0.75		
	2.37	3.12	30112-16	1.00		
	2.87	3.62	30116-16	1.00		
	2.62	3.37	30116-20	1.25		
5	2.37	3.12	3028-08	0.50	1-5/8	0.245
	2.31	3.06	3028-12	0.75		
	2.81	3.56	30212-12	0.75		
	2.37	3.12	30212-16	1.00		
	3.06	3.81	30214-12	0.75		
	2.62	3.37	30214-16	1.00		
	2.37	3.12	30214-20	1.25		
	2.87	3.62	30216-16	1.00		
6	2.62	3.75	30412-08	0.50	1-7/8	0.245
	2.56	3.69	30412-12	0.75		
	2.75	3.88	30414-12	0.75		
	2.87	4.00	30416-16	1.00		
	3.12	4.25	30420-20	1.25		