



STRAIGHT ELECTRODES, TRUNCATED NOSE “E” NOSE

**FEATURES AND SPECIFICATIONS**



**Features and Benefits**

- Long lasting, heavy duty electrode
- Can be used in many job shop applications
- Works with all industry standard holders
- Can be redressed many times
- Available in 3 standard materials
- “E” Nose used for aluminum
- Option larger diameter sizes available upon request

**Use With**

- 4RW or 5RW CMW Holders

**Mechanical**

- Electrical conductivity up to 90% IACS
- Rockwell hardness up to 100 HRB

ELECTRODES  
STRAIGHT

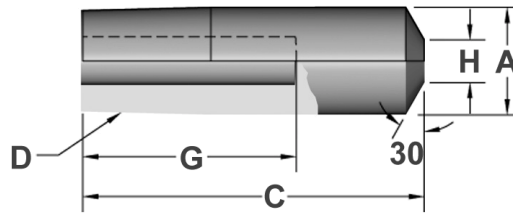

**ORDERING INFORMATION AND DIMENSIONS**

RWMA	Overall Length	Hole Depth	Part No.			Major Dia.	Face Dia.
			Material				
			CMW®28 Class 1	CMW®33 Class 2	CMW®100 Class 3		
D	C	G			A	H	
4	1-1/4	3/4	1712	3715	5715	.482	3/16
	1-1/2	1	1713	3717	5717		
	2	1-1/2	1715	3718	5718		
	2-1/2	2	1717	3723	5723		
	2-3/4	2-1/4	1718	3725	5725		
5	1-1/2	3/4	1723	3727	5727	.625	1/4
	2	1-1/4	1725	3729	5729		
	2-1/2	1-3/4	1727	37218	57218		
	3	2-1/4	1729	3729	5729		
	4	3-1/4	17218	37218	57218		