



SINGLE BEND ELECTRODES, RADIUS BEND

FEATURES AND SPECIFICATIONS

Features and Benefits

- Designed for hard to reach locations with space constraints
- Long lasting, heavy duty electrode
- Can be used in many job shop applications
- Works with all industry standard holders
- Can be redressed many times
- CMW®3 material

Use With

- Fits 5RW CMW standard holders

Mechanical

- Electrical conductivity up to 80% IACS
- Rockwell hardness up to 83 HRB

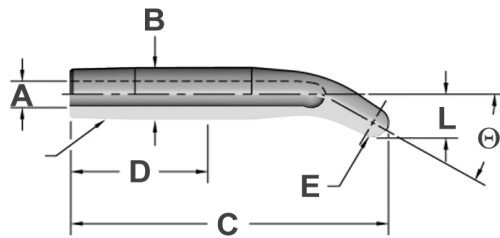

ELECTRODES
BENT

ORDERING INFORMATION AND DIMENSIONS

TAPER	BENT ANGLE	PART NO.	OVERALL LENGTH C	OFFSET CL OF TAPER TO TOP OF RADIUS L	HOLE DIA. A	DIA. B	MIN. STRAIGHT LENGTH D	NOSE RADIUS E
RWMA 5	15°	16-26015	3-11/16	3/8	5/16	.625	1-5/8	316
	30°	16-26030	3-5/8	33/64				
	45°	16-26045	3-1/2	43/64				
	60°	16-26060	3-3/8	27/32				
	75°	16-26075	3-7/64	1-1/32				
	90°	16-26090	2-13/16	1-1/4				