



**FEATURES AND SPECIFICATIONS**

**Features and Benefits**

- Elkonite® 10W3 faced CMW®3 material
- Insulated pin made of anodized aluminum
- Treated to 55 HRC for wear resistance

**Use With**

- All tapered electrode holders

**Mechanical**

- Use with flat faced electrodes

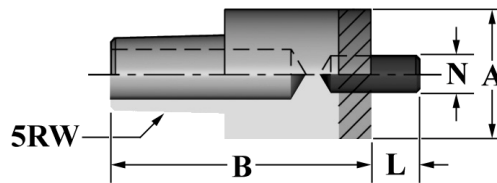

ELECTRODES  
STUD/NUT

**ORDERING INFORMATION AND DIMENSIONS**

TAPER	PIN DIA.	FOR NUT THREAD SIZE "N"	PIN LENGTH	PART NO.	OVERALL DIA.	OVERALL LENGTH
	N		L		A	B
RWMA 5	.166	#12	.375	16-3765-12	1	2
	.189	6.0mm		16-3765-M6		
	.192	1/4"		16-3765-25		
	.223	7.0mm		16-3765-M7		
	.252	8.0mm		16-3765-M8		
	.257	5/16"		16-3765-31		
	.291	9.0mm		16-3765-M9		