

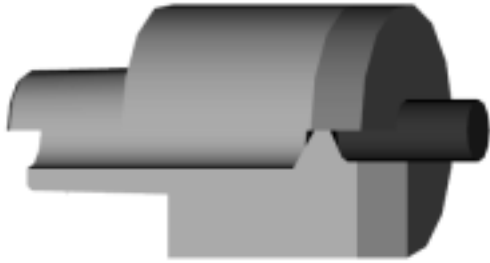

FEATURES AND SPECIFICATIONS



Features and Benefits

- Elkonite® 10W3 faced CMW®3 material
- Insulated pin made of anodized aluminum
- Treated to 55 HRC for wear resistance

Use With

- All tapered electrode holders

Mechanical

- Use with flat faced electrodes

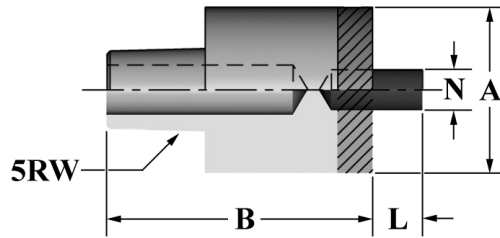

ELECTRODES
STUD/NUT

ORDERING INFORMATION AND DIMENSIONS

TAPER	PIN DIA.	FOR NUT THREAD SIZE "N"	PIN LENGTH	PART NO.	OVERALL DIA.	OVERALL LENGTH
	N		L		A	B
RWMA 5	.306	3/8"	.375	16-3766-38	1-3/4	2
	.320	10mm		16-3766-M10		
	.359	11mm		16-3766-M11		
	.361	7/16"		16-3766-44		
	.388	12mm		16-3766-M12		
	.415	1/2"		16-3766-50		
	.455	14mm		16-3766-M14		