



FEATURES AND SPECIFICATIONS

Features and Benefits

- Cold formed CMW®3
- Large flat face for cosmetic welds

Use With

- All tapered electrode holders

Mechanical

- CMW®3 material

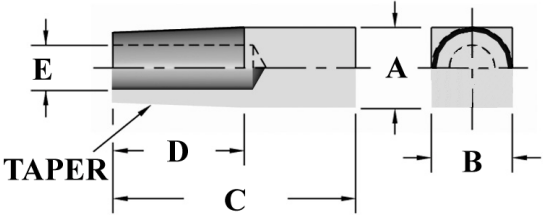

ORDERING INFORMATION AND DIMENSIONS

TAPER	DIMENSIONS (in inches)			PART NO.	DIMENSIONS (in inches)		MATERIAL
	A	B	C OVERALL LENGTH		D	E	
4	1/2	1/2	1-1/2	16-3110	13/16	9/32	CMW3
5	5/8	5/8	1-3/4	16-3120	7/8	3/8	
5	15/16	1/2	1-5/8	16-384110	7/8		

ELECTRODES
SPECIALTY