

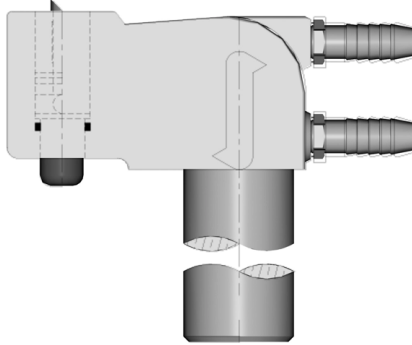

**HOLDERS (500 SERIES PREMIUM) (EJECTOR)  
WATER COOLED OFFSET 90°**

**FEATURES AND SPECIFICATIONS**



**Features and Benefits**  
 - Heavy duty holder  
 - For demanding applications

**Use With**  
 - All standard electrodes

**Mechanical**  
 - RWMA 5 & 7 tapers

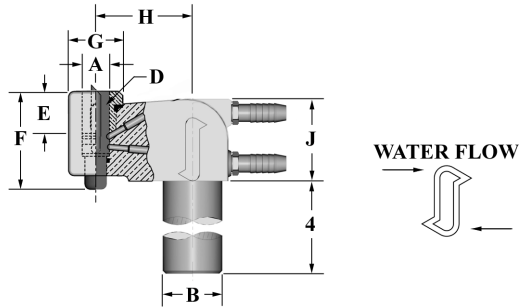

**ORDERING INFORMATION AND DIMENSIONS**

D	ANGLE OF HEAD	A	B	PART NO	E	F	G	H	J	11
RWMA TAPER	ANGLE OF HEAD	MAJOR TAPER DIA.*	SHANK DIA.*	HOLDER ASSEMBLY	STANDARD TAPER ENGAGEMENT*	HEAD HEIGHT*	HEAD DIA*	C.L. SHANK OFFSET*	HEAD THICKNESS*	SLIDING TUBE (REPLACEMENT PART)
5	90°	0.625	1	18-502	3/4	1-13/16	1-1/4	2	1-23/32	18-40043-3
			1-1/4	18-503						
			1-1/2	18-504						
7		0.875	1-1/4	18-505	1-1/8	2-7/32	1-1/2			
			1-1/2	18-506						
5		0.625	1	18-522	3/4	1-13/16	1-1/4			
			1-1/4	18-523						
			1-1/2	18-524						
7		0.875	1-1/4	18-525	1-1/8	2-7/32	1-1/2			
			1-1/2	18-526						

\*DIMENSIONS (in inches)

HOLDERS