



FEATURES AND SPECIFICATIONS



Features and Benefits

- Bent electrodes are for hard to reach locations
- Long lasting, heavy duty electrode
- Can be used in many job shop applications
- Works with all industry standard holders
- Can be redressed many times
- Material is CMW®3

Use With

- Fits 4RW or 5RW CMW standard holders

Mechanical

- Electrical conductivity up to 80% IACS
- Rockwell hardness up to 83 HRB

ELECTRODES
BENT

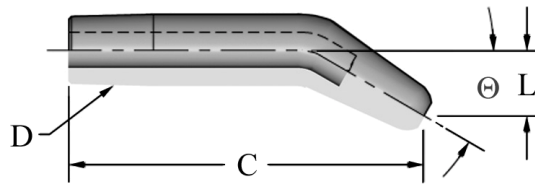

ORDERING INFORMATION AND DIMENSIONS

TAPER	BENT ANGLE	PART NO.	REFERENCE LENGTH TO CL OF FACE	OFFSET TAPER TO CL OF FACE
D			C	L
RWMA 4	15°	3214-04-15	1-11/16	1/4
		3219-04-15	2-15/16	1/4
		32118-13-15	3-7/8	13/16
	30°	3215-07-30	1-7/8	7/16
		3219-07-30	2-7/8	7/16
		32118-23-30	3-5/8	1-7/16
	45°	3215-10-45	1-11/16	5/8
		32112-12-45	2-7/8	3/4
		32118-33-45	3-1/8	2-1/16
	60°	3218-23-60	2	1-7/16
		32116-23-60	3	1-7/16
		32118-40-60	2-5/8	2-1/2

TAPER	BENT ANGLE	PART NO.	REFERENCE LENGTH TO CL OF FACE	OFFSET TAPER TO CL OF FACE
D			C	L
RWMA 5	15°	3225-04-15	1-7/8	1/4
		3229-04-15	2-7/8	1/4
		32218-10-15	3-13/16	5/8
	30°	3226-09-30	2-1/16	9/16
		32212-09-30	3-1/16	9/16
		32220-24-30	3-13/16	1-1/2
	45°	3228-17-45	2-1/4	1-1/16
		32214-17-45	3	1-1/16
		32220-33-45	3-3/8	2-2/16
	60°	32212-25-60	2-3/8	1-9/16
		32218-25-60	3-1/8	1-9/16
		32220-38-60	3	2-3/8
	75°	32216-35-75	2-5/16	2-3/16
		32220-37-75	2-11/16	2-5/16
		32220-43-75	2-3/8	2-11/16