



**FEATURES AND SPECIFICATIONS**

**Features and Benefits**

- Elkonite® 10W3 faced CMW®3 material
- Insulated pin made of anodized aluminum treated to 55 HRC for wear resistance
- Pin pushed down by upper electrode
- Spring returns pin to proper position

**Use With**

- Threaded electrode holders and adapters

**Mechanical**

- Has wrench flat
- Use with flat faced electrodes

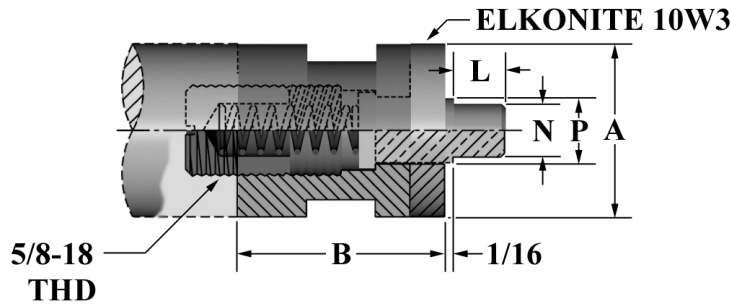
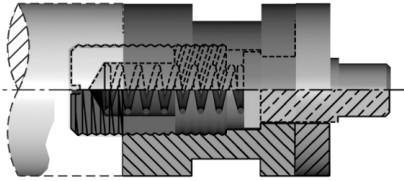

**ORDERING INFORMATION AND DIMENSIONS**

THREAD SIZE	PIN DIA.	FOR NUT THREAD SIZE "N"	PILOT LENGTH	PILOT DIA.	PART NO.	OVERALL DIA.	OVERALL LENGTH
	N		L	P		A	B
5/8-18	.166	#12	.375	.250	16-3786-12	1-1/4	1-1/2
	.186	6 mm		.269	16-3786-M6		
	.192	1/4"		.283	16-3786-25		
	.252	8 mm		.348	16-3786-M8		
	.257	5/16"		.345	16-3786-31		
	.306	3/8"		.408	16-3786-38		
	.320	10 mm		.427	16-3786-M10		
	.359	11 mm		.466	16-3786-M11		
	.361	7/16"		.470	16-3786-44		
	.388	12 mm		.470	16-3786-M12		
	.415	1/2"		.533	16-3786-50		