



## CAPS, TRUNCATED "E" NOSE MALE AND FEMALE ELECTRODES

### FEATURES AND SPECIFICATIONS

#### Features and Benefits

- Low cost electrode system
- Applications requiring frequent changeovers
- Available in RWMA 4-7 tapers
- Large weld face
- Works with all industry standard shanks
- Caps can be redressed
- Available in CMW®28, CMW®3, or CMW®328 material
- "E" Nose good for standard duty design and aluminum
- Male version provides optimal cooling

- Female version allows "dry" change when on blind hole shanks

#### Use With

- CMW shanks
- All CMW holders
- Dressing Tools

#### Mechanical

- Electrical conductivity up to 90% IACS
- Rockwell hardness up to 83 HRB

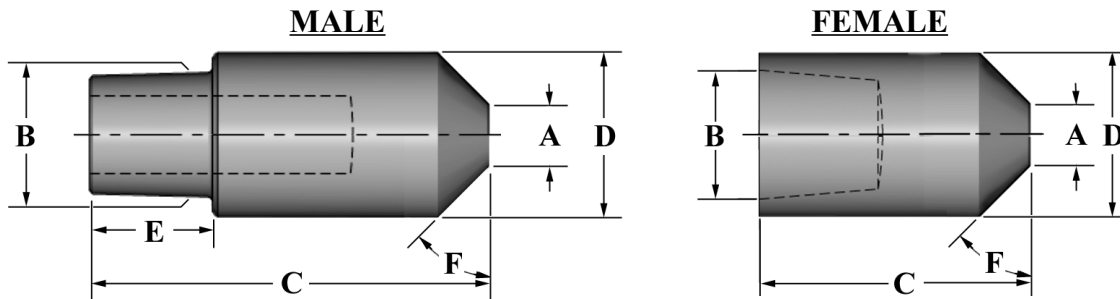
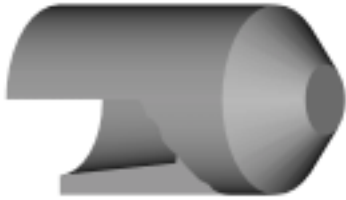

### ORDERING INFORMATION AND DIMENSIONS

STYLE	RWMA	ORDER NO.			DIMENSIONS (in inches)					USE WITH	
		MATERIAL			WELD FACE A	ENGAGEMENT LINE DIA. B	LENGTH C	O.D. D	GAGE LENGTH (MALE CAPS) E	FACE ANGLE F	SHANK
		CMW®28 CLASS 1	CMW®3 CLASS 2	CMW®328 CLASS 2							
MALE	4	ME14Z	ME24	ME24Z	0.188	0.3745	1.125	0.500	0.285	45°	301XX
	5	ME15Z	ME25	ME25Z	0.250	0.4145	1.250	0.625	0.390		302XX
	6	ME16Z	ME26	ME26Z	0.313	0.5005	1.625	0.750	0.500		304XX
FEMALE	4	MPE14Z	MPE24	MPE24Z	0.188	0.3945	0.840	0.500	N/A	45°	MP301XX
	5	MPE15Z	MPE25	MPE25Z	0.250	0.4951	0.880	0.625			MP302XX
	6	MPE16Z	MPE26	MPE26Z	0.313	0.6255	1.000	0.750			MP304XX

\*Taper Length for RWMA 4/5/6, Male = 3/8", 1/2", 5/8", Female = 7/8", 3/4", 7/8"